

Application for Wind Energy Facility Siting Permitting

Flickertail Wind, LLC

Eddy County, ND

November 17, 2025

Prepared for:



Prepared by:

Westwood

Contents

1.0 Introduction3

2.0 Regulatory Framework.....4

3.0 Application for the Wind Energy Facility Siting Permit.....5

 3.1 Prospective Permittee:5

 3.2 USGS Topographic Map(s) (plus 500 ft buffer):6

 3.3 Schedule and Timeline.....9

 3.4 Leases, Easements, and Agreements9

4.0 Compliance with § 10.1.4 Requirements 10

 4..1 Proposed Turbine Layout Table 10

 4.2 Color..... 11

 4.3 Advertising 11

 4.4 Identification Number 11

 4.5 Lighting 11

 4.6 Material & Color..... 11

 4.7 Minimal Impacts..... 12

 4.8 Fences 12

 4.9 Road Maintenance..... 12

 4.10 Collector Lines 12

 4.11 Feeder Line..... 13

5.0 Set Back Compliance 13

 5.1 Building Set Back..... 13

6.0 Restoration of Property 13

7.0 Road Protection 14

8.0 Transfer of Wind Energy Facility Siting Permit..... 14

9.0 Final Compliance and Acknowledgement..... 15

Tables

Table 3-1: Turbine Location Information.....6

Table 3-2: Project Schedule Estimated Completion.....9

Table 4-1: Proposed Turbine Model Specifications10

Appendices

Appendix A: Maps

 Map 1 - Project Location and Design

 Map 2 – Existing Infrastructure

 Map 3 – Bush Township Project Design and Existing Infrastructure

 Map 4 – Gates Township Project Design and Existing Infrastructure

 Map 5 – Munster Township Project Design and Existing Infrastructure

 Map 6 – Sheldon Township Project Design and Existing Infrastructure

 Map 7 – Rosefield Township Project Design and Existing Infrastructure

Appendix B: Participating Landowner List and Memorandum of Real Estate Agreements

1.0 Introduction

Flickertail Wind, LLC (Flickertail, Flickertail Wind or Applicant) respectfully submits this Application to the Eddy County Zoning Commission (Commission) for a Wind Energy Facility Siting Permit (Permit) to construct and operate that portion of the Flickertail Wind Project (Project) proposed within Munster, Gates, Bush, Rosefield, and Sheldon townships in Eddy County (Permit Area). The portion of the Project proposed in New Rockford and Grandfield townships will be permitted separately through those jurisdictions per ECZO § 1.4.

The Flickertail Wind Project includes Project Facilities within an area of approximately 55,000 acres of leased land in Eddy and Wells counties, including up to 113 wind turbine generators (to allow for primary and alternate turbine locations) along with a dedicated Project substation, an approximately 13-mile 345kV feeder line, access roads, an operations and maintenance (O&M) facility, two permanent meteorological towers (MET), an aircraft detection lighting system (ADLS) tower, and underground collection facilities (all together, the Project, Facilities or Project Facilities).

Flickertail proposes the construction of up to 75 wind turbines and associated balance of plant facilities within Munster, Gates, Bush, Rosefield, and Sheldon townships in Eddy County. Proposed balance of plant facilities include collection lines, access roads, one permanent MET, and approximately 10.5 miles of feeder line. The physical footprint of the proposed Facilities is generally located in the western third of the Eddy County.

This Project is a wind energy conversion system (WECS), as defined in the Wind Energy Facility chapter of the North Dakota Century Code (NDCC), Chapter 69-06-11, Section 01(6), as any plant, addition, or combination of plant and addition, designed for or capable of generation by wind energy conversion exceeding one-half megawatt of electricity. The Applicant proposes to construct, operate, and maintain the Project in Wells and Eddy counties as shown on the maps in **Appendix A**.

2.0 Regulatory Framework

ECZO § 10.1.2

This Application has been prepared following the Eddy County Zoning Ordinance (ECZO) as amended July 28, 2025 and provides information as required to comply with Article 10 – Wind Energy Facilities regarding the siting and development of a Wind Energy Facility in the county.

According to the Eddy County Zoning Map, the Permit Area is zoned Agricultural except within organized cities enacting their own zoning regulations pursuant to NDCC Chapters 40-07 and 58-03. The Agricultural zoning district is for the preservation and protection of agricultural lands, avoiding uses incompatible with agricultural lands or operations.

Eddy County zoning (ECZO) separately addresses conditional uses in Agricultural zones for standalone ‘transmission line’ facilities (Section 5.1.3.4) and Wind Energy Facilities, or ‘WEF’ (Article 10). The WEF rules and process in Article 10 comprehensively address all facilities and infrastructure associated with the Project in Eddy County.

The Project is an integrated and interconnected system, with the turbines connected together and to the power grid by electrical wire and communication lines, roads, and other infrastructure necessary for its operation. As a critical, ancillary component necessary for the operation of the turbines, the Project's internal collector lines and feeder line are proposed to be permitted as integral facilities under the overarching Wind Energy Facility Siting Permit outlined in Article 10.

This unified approach ensures all infrastructure is reviewed concurrently and governed by the same set of performance standards and conditions specific to the WEF. The Project will require a Wind Energy Facility Siting Permit and building permits from the County.

The Project infrastructure has been sited in collaboration with participating landowners and the neighboring community members in order to minimize disruption to existing agricultural operations within the Permit Area.

3.0 Application for the Wind Energy Facility Siting Permit

3.1 Prospective Permittee:

ECZO § 10.1.3.1.1

Flickertail Wind respectfully submits this Application for a Wind Energy Facility Siting Permit to the Eddy County Zoning Commission (Commission). This Application seeks authorization to construct and operate that portion of the Project proposed within Munster, Gates, Bush, Rosefield, and Sheldon townships in Eddy County.

Permittee Flickertail Wind, LLC
Contact Wells McGiffert, VP Business Development, PRC Wind
Address 901 N 3rd Street, Suite 220, Minneapolis, MN 55401
Phone (612) 331-1486

Flickertail Wind understands that no work, except for wind monitoring, soil testing and other survey work, may commence to construct a wind energy facility until the Wind Energy Facility Siting Permit (permit) has been issued by Eddy County Commission.

The fee for this Application is provided at the time of submission.

Signature of Authorized Representative of the Prospective Permittee:



Wells McGiffert, VP Business Development, PRC Wind on behalf of Flickertail Wind, LLC

3.2 USGS Topographic Map(s) (plus 500 ft buffer):

ECZO § 10.2.3.1.2

A USGS topographical map of that portion of the Project Facilities within the Permit Area and including 500 feet of all adjoining properties along the Project Facility perimeter, showing all existing features, including property boundaries, structures, improvements, roads, utility lines, public facilities and natural features, location of all proposed improvements for, including numbered wind turbines, feeder line, permanent MET tower, and access roads is shown in **Appendix A**. Each proposed wind turbine, as numbered, has been included in **Table 3-1** along with information on distances from property lines and existing improvements.

TABLE 3-1: TURBINE LOCATION INFORMATION

| Turbine # | Twp | Distance to Nearest (ft) | | | | | | | |
|-----------|---------|--------------------------|--------------|-------------------|------------|------------|----------|---------------|-------------------|
| | | Road | Gas Pipeline | Transmission Line | Substation | Water Well | Gas Well | Property Line | Occupied Receptor |
| T018 | Munster | 1,406 | 22,800 | 19,664 | 28,768 | 6,162 | 23,074 | 332 | 4,820 |
| T029 | Munster | 839 | 1,801 | 9,380 | 22,496 | 7,859 | 21,412 | 135 | 6,997 |
| T030 | Munster | 848 | 2,270 | 9,704 | 19,496 | 6,245 | 24,962 | 637 | 5,329 |
| T031 | Munster | 851 | 4,657 | 9,701 | 18,014 | 6,259 | 23,894 | 849 | 4,560 |
| T032 | Munster | 951 | 6,543 | 954 | 7,732 | 2,033 | 16,884 | 351 | 4,720 |
| T033 | Munster | 990 | 7,290 | 994 | 9,726 | 3,990 | 18,794 | 992 | 3,573 |
| T034 | Munster | 804 | 5,728 | 908 | 11,484 | 5,839 | 21,064 | 801 | 3,199 |
| T035 | Munster | 1,889 | 3,601 | 1,896 | 12,952 | 7,414 | 22,686 | 466 | 2,367 |
| T036 | Munster | 804 | 4,401 | 6,110 | 16,288 | 9,453 | 26,495 | 794 | 2,141 |
| T037 | Munster | 863 | 1,579 | 6,773 | 18,091 | 9,225 | 28,291 | 153 | 2,690 |
| T038 | Munster | 970 | 5,292 | 9,596 | 19,764 | 6,900 | 30,107 | 970 | 4,460 |
| T046 | Gates | 868 | 16,114 | 11,437 | 23,601 | 5,343 | 26,623 | 667 | 4,318 |
| T047 | Gates | 845 | 18,099 | 12,462 | 20,888 | 5,046 | 28,670 | 759 | 3,560 |
| T048 | Gates | 989 | 20,302 | 12,884 | 18,353 | 6,008 | 27,230 | 918 | 5,730 |
| T049 | Gates | 1,095 | 26,416 | 10,712 | 18,816 | 3,965 | 29,659 | 229 | 3,290 |
| T050 | Gates | 2,549 | 29,006 | 9,089 | 18,167 | 2,303 | 31,047 | 93 | 2,343 |
| T051 | Gates | 850 | 31,583 | 7,385 | 17,878 | 716 | 32,609 | 77 | 2,176 |
| T052 | Gates | 1,461 | 8,311 | 7,452 | 21,963 | 4,650 | 33,867 | 1,159 | 1,957 |
| T053 | Gates | 1,722 | 10,000 | 3,899 | 23,513 | 5,667 | 37,548 | 540 | 4,955 |

| | | | | | | | | | |
|------|-------|-------|--------|--------|--------|--------|--------|-------|-------|
| T054 | Gates | 2,262 | 14,115 | 2,324 | 23,394 | 5,407 | 36,150 | 299 | 6,048 |
| T055 | Gates | 1,434 | 15,950 | 2,689 | 21,868 | 5,801 | 35,268 | 732 | 5,226 |
| T056 | Gates | 831 | 17,045 | 1,609 | 22,180 | 7,620 | 31,485 | 88 | 5,722 |
| T057 | Gates | 2,143 | 19,672 | 1,876 | 25,887 | 3,854 | 34,571 | 404 | 9,691 |
| T058 | Gates | 3,262 | 20,975 | 4,067 | 26,528 | 3,293 | 33,114 | 387 | 9,592 |
| T059 | Gates | 3,649 | 21,738 | 5,414 | 25,993 | 4,365 | 31,224 | 663 | 8,687 |
| T060 | Gates | 804 | 22,701 | 6,401 | 24,069 | 7,458 | 28,092 | 502 | 6,657 |
| T061 | Gates | 1,823 | 23,388 | 11,683 | 28,468 | 6,763 | 26,878 | 197 | 6,415 |
| T062 | Gates | 2,993 | 20,329 | 12,867 | 28,807 | 7,997 | 25,774 | 351 | 6,299 |
| T063 | Gates | 848 | 21,185 | 7,536 | 23,302 | 9,063 | 26,016 | 768 | 6,282 |
| T064 | Gates | 805 | 24,481 | 10,230 | 25,071 | 9,320 | 24,550 | 602 | 5,088 |
| T065 | Gates | 2,937 | 25,262 | 12,259 | 25,470 | 7,934 | 22,260 | 303 | 3,504 |
| T066 | Gates | 1,208 | 24,959 | 8,063 | 22,141 | 10,996 | 24,162 | 105 | 4,570 |
| T067 | Gates | 853 | 28,075 | 7,720 | 20,676 | 10,060 | 23,095 | 476 | 4,054 |
| T068 | Gates | 1,463 | 27,140 | 12,046 | 24,072 | 8,584 | 20,736 | 229 | 1,610 |
| T069 | Gates | 828 | 27,098 | 8,145 | 19,497 | 7,855 | 21,224 | 45 | 3,209 |
| T070 | Gates | 1,182 | 28,760 | 7,650 | 17,979 | 6,211 | 20,358 | 460 | 3,878 |
| T071 | Gates | 810 | 27,210 | 9,606 | 19,267 | 5,408 | 18,539 | 811 | 2,499 |
| T072 | Gates | 1,445 | 30,042 | 11,757 | 20,882 | 5,428 | 16,640 | 389 | 2,392 |
| T073 | Gates | 938 | 32,886 | 13,333 | 23,655 | 8,658 | 17,936 | 936 | 1,996 |
| T074 | Bush | 838 | 27,057 | 16,616 | 27,254 | 5,208 | 17,811 | 399 | 4,345 |
| T075 | Bush | 1,422 | 26,599 | 17,959 | 26,834 | 7,640 | 14,080 | 117 | 3,725 |
| T076 | Bush | 1,087 | 16,424 | 20,750 | 30,846 | 3,913 | 16,743 | 1,085 | 1,789 |
| T077 | Bush | 1,314 | 11,438 | 23,185 | 31,978 | 3,007 | 13,940 | 1,064 | 1,877 |
| T078 | Gates | 1,392 | 18,623 | 4,547 | 13,865 | 5,160 | 21,084 | 945 | 5,271 |
| T079 | Gates | 1,411 | 20,136 | 845 | 8,204 | 1,498 | 24,821 | 944 | 1,470 |
| T080 | Gates | 1,417 | 20,798 | 824 | 9,462 | 2,228 | 23,188 | 745 | 2,290 |
| T081 | Gates | 1,446 | 20,821 | 7,474 | 13,175 | 3,149 | 16,689 | 112 | 2,685 |
| T082 | Gates | 814 | 22,713 | 10,051 | 15,552 | 2,087 | 14,236 | 507 | 2,005 |

| | | | | | | | | | |
|------|---------|-------|--------|--------|--------|--------|--------|-------|-------|
| T083 | Gates | 914 | 19,428 | 12,784 | 17,802 | 1,244 | 12,159 | 404 | 1,470 |
| T084 | Gates | 2,526 | 17,952 | 12,504 | 18,939 | 2,553 | 11,099 | 95 | 2,388 |
| T085 | Bush | 2,459 | 12,860 | 13,917 | 20,367 | 3,463 | 9,673 | 158 | 3,366 |
| T086 | Bush | 1,896 | 14,237 | 15,226 | 21,533 | 4,226 | 8,384 | 733 | 4,190 |
| T087 | Bush | 1,842 | 12,722 | 16,367 | 22,689 | 3,192 | 7,230 | 160 | 5,201 |
| T088 | Bush | 1,038 | 12,127 | 17,814 | 23,952 | 1,676 | 5,851 | 1,036 | 3,940 |
| T089 | Bush | 1,936 | 10,102 | 18,888 | 23,591 | 4,604 | 7,898 | 724 | 2,241 |
| T090 | Bush | 1,607 | 2,122 | 18,631 | 23,727 | 3,421 | 7,018 | 114 | 1,689 |
| T091 | Bush | 800 | 547 | 20,618 | 26,373 | 1,410 | 3,741 | 103 | 2,218 |
| T092 | Bush | 2,092 | 1,133 | 22,511 | 28,027 | 904 | 3,319 | 125 | 2,769 |
| T093 | Bush | 2,937 | 13,026 | 23,062 | 28,321 | 1,139 | 4,200 | 292 | 2,907 |
| T094 | Sheldon | 977 | 20,387 | 16,682 | 30,656 | 4,470 | 35,031 | 963 | 5,758 |
| T095 | Sheldon | 812 | 21,566 | 16,516 | 32,220 | 5,927 | 33,607 | 790 | 4,000 |
| T096 | Sheldon | 1,267 | 16,038 | 17,541 | 34,659 | 4,460 | 30,894 | 805 | 2,047 |
| T097 | Sheldon | 1,461 | 18,722 | 19,523 | 36,586 | 2,642 | 29,774 | 716 | 3,089 |
| T098 | Sheldon | 800 | 20,584 | 18,462 | 34,932 | 4,858 | 27,509 | 269 | 2,622 |
| T099 | Bush | 1,023 | 16,358 | 21,348 | 35,376 | 3,848 | 24,187 | 753 | 2,042 |
| T100 | Bush | 1,232 | 20,284 | 24,189 | 37,897 | 5,716 | 24,595 | 1,034 | 2,072 |
| T101 | Bush | 839 | 16,502 | 18,794 | 29,052 | 4,229 | 16,980 | 835 | 3,192 |
| T102 | Bush | 1,402 | 21,682 | 18,359 | 29,414 | 3,108 | 18,503 | 393 | 4,367 |
| T104 | Munster | 1,592 | 13,347 | 1,990 | 17,624 | 12,001 | 27,029 | 658 | 2,625 |
| T105 | Munster | 2,191 | 13,289 | 2,192 | 18,920 | 13,297 | 25,980 | 226 | 3,369 |
| T106 | Munster | 2,528 | 13,378 | 2,754 | 20,061 | 12,915 | 25,306 | 111 | 4,059 |
| T110 | Munster | 1,159 | 6,846 | 7,081 | 13,717 | 8,572 | 24,085 | 166 | 2,199 |
| T111 | Gates | 881 | 18,093 | 9,311 | 28,632 | 3,722 | 29,921 | 480 | 7,176 |
| T112 | Gates | 925 | 17,438 | 8,761 | 25,427 | 7,376 | 26,761 | 791 | 7,171 |
| T113 | Munster | 1,720 | 6,039 | 8,041 | 14,703 | 7,519 | 25,084 | 120 | 2,580 |

The final design of the Project within the Permit Area will be informed by and compliant with the ECZO requirements and consider feedback from Commissioners and residents. Following completion of

construction of the Project, Flickertail Wind will submit a final USGS topographical map, or survey if available, with all information pursuant to Section 10.1.3.1.2 of the ECZO.

3.3 Schedule and Timeline

ECZO § 10.1.3.1.4

Flickertail Wind will obtain all permits and approvals required for the Project prior to beginning construction. Construction is anticipated to start in Q3 2026 and will take approximately 12 to 18 months of construction work to complete over a two-year period, allowing for winter stoppages. The draft construction schedule is included below and is subject to change.

Flickertail Wind personnel will manage primary construction contractors regarding roads, turbine assembly, electrical, and communications. Construction will begin with workforce mobilization and the initial site preparation work including grading and vegetation removal. **Table 3-2** shows the Project milestones needed to achieve a commercial operation date (COD) in Q4 of 2028.

TABLE 3-2: PROJECT SCHEDULE ESTIMATED COMPLETION

| Task Name | Start | Finish |
|--|------------|------------|
| Site Prep Work | 10/15/2026 | 12/15/2026 |
| Winter Stoppage 2027 | 12/15/2026 | 04/14/2027 |
| Roads, Crane Pads, Laydown Yard – Year 1 | 04/19/2027 | 12/15/2027 |
| Winter Stoppage 2028 | 12/15/2027 | 04/13/2028 |
| Roads, Crane Pads, Laydown Yard – Year 2 | 04/13/2028 | 10/10/2028 |
| Foundations | 04/26/2028 | 11/09/2028 |
| Collections | 05/13/2028 | 11/9/2028 |
| Turbine Erection | 04/13/2028 | 8/11/2028 |
| Commissioning | 08/11/2028 | 11/9/2028 |
| COD | 11/09/2028 | 11/9/2028 |

3.4 Leases, Easements, and Agreements

ECZO § 10.1.3.1.5

Flickertail Wind has real estate rights in place for property where the Project Facilities are proposed to be located within the Permit Area. All such properties are privately owned and are under agreement with Flickertail for the entire duration of the Project. A list of participating landowners and copies of recorded memoranda of real estate agreements are included in **Appendix B**.

The Project will have positive economic impacts for the local community and region driven by direct payment revenues to real estate and business owners, local governments, and non-governmental organizations, and through direct and induced employment associated with the Project. Compensation is made to landowners for any temporary impacts on crop farming. Agricultural activities, including both grazing and cultivation, will be able to continue as usual in the Permit Area during and after the life of the Project.

4.0 Compliance with § 10.1.4 Requirements

ECZO § 10.1.4

The ECZO requires the Applicant to comply with regulations outlined in *Article 10 – Wind Energy Facilities* prior to development, construction, and operation of a wind energy facility or part thereof within the Eddy County’s jurisdiction.

Flickertail Wind includes the information required by the Energy Conversion and Transmission Facility Siting Act (NDCC Chapter 49-22) and the North Dakota Public Service Commission’s (NDPSC) Siting Regulations (NDAC Article 69-06). Flickertail Wind has considered the exclusion and avoidance areas, the selection criteria, and the policy criteria in the design of the Project, in accordance with NDCC Chapter 49-22 and NDAC Section 69-06-08-01. Information regarding Project design, wind resources, and technical information has been included in this Application to allow a thorough understanding of the Project and support review by local governments, the NDPSC, regulatory agencies, and the public.

4.1 Proposed Turbine Layout Table

The Applicant has evaluated several alternate turbine models ranging from 3 to 6 MW rating for the Project. The Project complies with all sound, shadow and other applicable regulations and rules with by employing all of those evaluated turbine models. Of the models evaluated, the Applicant anticipates employing the Nordex 5.9 MW model with a 163-meter (535-foot) rotor diameter, hub heights between 108- to 120-meters (355- to 394-feet) and total heights between 190 to 201.5 meters (624 to 661 feet; **Table 4-1**). Assumptions and calculations presented in this Application are based upon the specifications of the Nordex 5.9 MW turbine model, but the final turbine model and hub height may vary based on final Project design.

TABLE 4-1: PROPOSED TURBINE MODEL SPECIFICATIONS

| CHARACTERISTIC | TURBINE MODEL | |
|--------------------|-----------------|------------------|
| | NORDEX N163/5.9 | NORDEX N163/5.9 |
| NAMEPLATE CAPACITY | 5.9 MW | 5.9 MW |
| ROTOR DIAMETER | 163 M (535 FT) | 163 M (535 FT) |
| HUB HEIGHT | 108 M (355 FT) | 120 M (394 FT) |
| TOTAL HEIGHT | 190 M (624 FT) | 201.5 M (661 FT) |

The Applicant will finalize the purchase of wind turbines after permitting. All turbine models under consideration are major-brand, utility-scale turbines that are well-established in the United States and fully compliant with all applicable state, federal, and local codes and requirements. The Project’s environmental impacts will not exceed those described in this application regardless of the turbine model employed, and the turbines will be sited within the same real estate and proposed locations. The Applicant will finalize turbine selection and reaffirm compliance with all regulatory requirements prior to construction.

4.2 Color

ECZO § 10.1.4.1

All 75 proposed wind turbines will exhibit visual uniformity in the shape, color, and size of rotor blades, nacelles, and towers. The turbines will be uniform in color and painted white, grey, or other neutral non-reflective unobtrusive color designed to minimize visual impacts.

4.3 Advertising

ECZO § 10.1.4.2

No advertisements will be posted to any Project facilities. Signs posted to the turbine towers will only include those necessary for technical, safety, and location identification information.

4.4 Identification Number

ECZO § 10.1.4.3

Turbines will have street addresses and be numbered and clearly labeled for identification for emergency response. Flickertail Wind will provide a Wind Energy Facility map identifying precise turbine locations, addresses and corresponding numbers to local emergency response coordinators prior to commencement of operations.

4.5 Lighting

ECZO § 10.1.4.4

Lighting for facilities will not exceed the minimum required for safety and security. Lighting of ancillary structures will be minimized, and downward-facing lights and/or motion-sensing lights will be installed, as practicable. Turbine lighting will be restricted solely to the minimum requirements established by the Federal Aviation Administration (FAA) for aviation safety. Specifically, the Project will implement a Turbine Lighting Compliance Plan utilizing an Aircraft Detection Lighting System (ADLS) which adheres to the light-mitigating technology requirements specified in NDCC Section 49-22-16.4 and NDAC Chapter 69-06-11.

The Project will follow the standards for marking and lighting as defined in the FAA's Advisory Circulars regarding aviation safety. Chapter 13, Marking and Lighting Wind Turbines, in the regulations and policies document Advisory Circular 70/7460-1M, Obstruction Marking and Lighting, which applies specifically to marking and lighting wind farms. The permanent METs will be marked and lit as specified by the FAA. Additionally, the Project's permanent METs will comply with applicable state marking requirements.¹

4.6 Material & Color

ECZO § 10.1.4.5

¹ NDCC § 2-05: Aeronautics Commission.

The wind turbines will have an unobtrusive and neutral aesthetic in the shape, color, and size of rotor blades, nacelles, and towers. Collection lines will be buried. For facility buildings and other structures, low-profile structures will be chosen whenever possible to reduce their visibility. Turbine foundations and roads have been designed to minimize and balance cuts and fills.

Following construction, the temporarily disturbed areas outside of cropland will be reseeded with a seed mixture consistent with the surrounding vegetation and free of noxious weeds according to NRCS recommendations, unless otherwise specified by the landowner.

4.7 Minimal Impacts

ECZO § 10.1.4.6

The final Project design (submitted as part of this application) has been designed to prioritize the utilization of existing field edges, property lines, and landowner input to minimize, to the greatest extent possible, disruption to active agricultural areas. Construction Best Management Practices (BMPs), including soil erosion and sediment control plans, will be strictly followed to protect water drainage and minimize landscape impacts. Temporary access areas will be restored.

4.8 Fences

ECZO § 10.1.4.7

Flickertail Wind will repair or replace any fences or gates damaged or removed during all phases of the Project's life resulting from construction or operation, unless a specific alternative is negotiated with the landowner. Furthermore, where temporary or permanent gates are installed in existing electric fences, the Applicant will ensure electrical continuity is maintained across the gate opening (e.g. using buried insulated cable) and that property owner rules are followed for gate operation.

4.9 Road Maintenance

ECZO § 10.1.4.8

Flickertail Wind will ensure that any damage to county roads, resulting from construction, operation, or decommissioning of the Project, is repaired or restored to a condition equal to or better than the condition prior to construction at Flickertail cost. Road maintenance will be covered in the Road Use Agreement discussed in Section 7.0 of this Application.

4.10 Collector Lines

ECZO § 10.1.4.9

All collector lines (electrical lines connecting individual turbines) and communication cables on private property will be installed underground to a minimum depth of 48" per industry standards. These lines will be co-located within or immediately adjacent to the new access roads wherever practical to minimize ground disturbance. Any necessary variance from this co-location standard will be specifically negotiated with the affected landowner.

4.11 Feeder Line

ECZO § 10.1.4.10

The Project feeder line will run north-south from the Project Substation in the central Project Area in Grandfield Township to the proposed switchyard location in Rosefield Township, Eddy County as shown on map in **Appendix A: Maps 1, 5 and 7**.

5.0 Set Back Compliance

ECZO § 10.1.5 (as amended 2025)

5.1 Building Set Back

ECZO § 10.1.5.1

The Project has been designed to minimize impacts to residences, farms, businesses, and public structures. Turbines will be located at least three times the turbine height from non-participating occupied dwellings and 1.1 times the turbine height from non-participating property lines in accordance with the ECZO.

6.0 Restoration of Property

ECZO § 10.1.7

Pursuant to NDAC Chapter 69-09-09, Flickertail Wind will submit a decommissioning plan to the NDPSD for approval prior to Project operation. Within 180 days of the termination of real estate rights for the wind facility, all facility structures will be removed according to real estate agreements and county code, and the ground surfaces will be restored or replaced.

Decommissioning will adhere to North Dakota Wind Turbine Decommissioning Guidelines (NDAC Chapter 69-09-09) and Eddy County ordinances (**ECZO Section 10.1.7**). At the end of commercial operation, and within 180 days of termination or abandonment of leases or easements for the wind energy facility, Flickertail Wind will be responsible for dismantling and removal of all Project Facilities to depths specified below.

Unless waived by the NDPSD in accordance with NDAC Chapter 69-09-09-05(2), decommissioning activities will include the following:

- Dismantling and removal of all towers, turbine generators, transformers, fencing, overhead cables, substations, and other equipment;
- Removal of underground cables to a depth of 24 inches (cables buried deeper than 24 inches may remain in place);
- Removal of foundations, structures, and ancillary equipment to a depth of four (4) feet;
- Site restoration and reclamation to the approximate original topography that existed prior to construction of the facility with topsoil respread over the disturbed areas at a depth similar to that in existence prior to the disturbance; and

- Grading and restoring topsoil of areas disturbed by the facility and reseeding according to NRCS recommendations, unless the Commission approves an owner request signed by the applicable landowner identifying the surface features the landowner would like to keep in place and the reason the landowner prefers to keep those features.

During decommissioning, the landowners will be consulted to identify the extent and type of work to be completed. Some infrastructure, such as the access roads, may be left in place at the landowners' requests.

Removed equipment and materials will be processed to size, loaded onto trucks, and hauled for off-site recycling or disposal. Turbine towers, nacelles, pad-mounted transformers, substation equipment, and other metal components will have considerable scrap value and will be hauled for recycling. Materials that cannot be recycled will be disposed of at authorized sites.

The Decommissioning Plan, approved by the ND PSC, including cost estimate, will be updated and re-filed ten (10) years after initial approval. It will then continue to be updated and filed every five (5) years until the end of the Project life.

7.0 Road Protection

ECZO § 10.1.4.8

Prior to construction, Flickertail Wind will coordinate with the applicable local and state road jurisdictional authorities to ensure that the increased traffic and additional weights being applied to area roads are acceptable, and to obtain all relevant agreements and permits for access and utility installation. Flickertail will execute a comprehensive road use agreement that will be used to identify suitable travel routes, traffic control measures, methods for evaluating, monitoring, and restoring roads, and mitigation measures to ensure Eddy County roads used for oversize/overweight loads are properly identified, monitored, and stabilized.

Applicable best management practices (BMPs) will be used during construction and operation of the Project to minimize dust emissions. Additional BMPs will be implemented as part of the Stormwater Pollution Prevention Plan (SWPPP) which will also address emissions (e.g., reducing vehicle and equipment speed, maintaining equipment and exhaust/mufflers, etc.). Additional practices may include watering or treating haul and access roads and other exposed dust producing areas, containment of excavated material, protection of exposed soil, soil stabilization, and treatment stockpiles to control fugitive dust. The Applicant will obtain a National Pollutant Discharge Elimination System (NPDES) Permit and prepare the required SWPPP, which will be developed prior to construction and implemented during construction, that will include BMPs to minimize to potential for fugitive dust.

8.0 Transfer of Wind Energy Facility Siting Permit

ECZO § 10.1.8

Flickertail Wind, LLC will own, operate, and maintain the Project during commercial operations. Flickertail Wind has entered into a Power Purchase Agreement (PPA) with Minnkota Power Cooperative that was announced on January 15, 2025. Any future owner, investor, or assignee of Flickertail Wind, LLC will be required to meet the Wind Energy Facility Siting Permit conditions as issued by Eddy County. Authorized representatives will follow the notification process as outlined in the ECZO for any transfer of the Project's permit.

9.0 Final Compliance and Acknowledgement

The final design of the Project will be informed by and compliant with the ECZO and consider feedback from Commissioners and residents. Within 90 days of completion of construction of the Project, Flickertail Wind will submit a final USGS topographical map, or survey if available, with all information pursuant to Section 10.1.3.4 of the Eddy County Zoning Ordinance.

Flickertail Wind proposes that the Eddy County Commission provide approval of minor modifications of the Project design as authorized under Section 10.1.3.4 of the ECZO, if requested, under the condition that any requested changes comply with all applicable zoning regulations. Minor modifications would be any shift in the location of a turbine, access road or other Project Facilities that remain within the same permitted parcel of land and does not violate any setback requirement or specific condition of this Permit.

Appendix A Map 1 - Project Location and Design

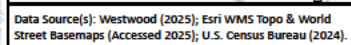

Eddy County, North Dakota

Exhibit 1

-

Appendix A Map 2 – Existing Infrastructure

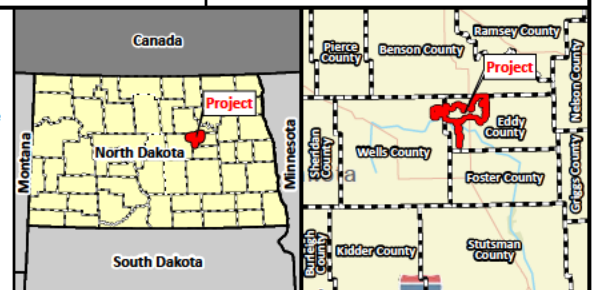
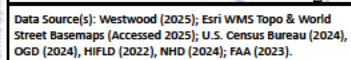

Appendix A Map 3 – Bush Township Project Design and Existing Infrastructure

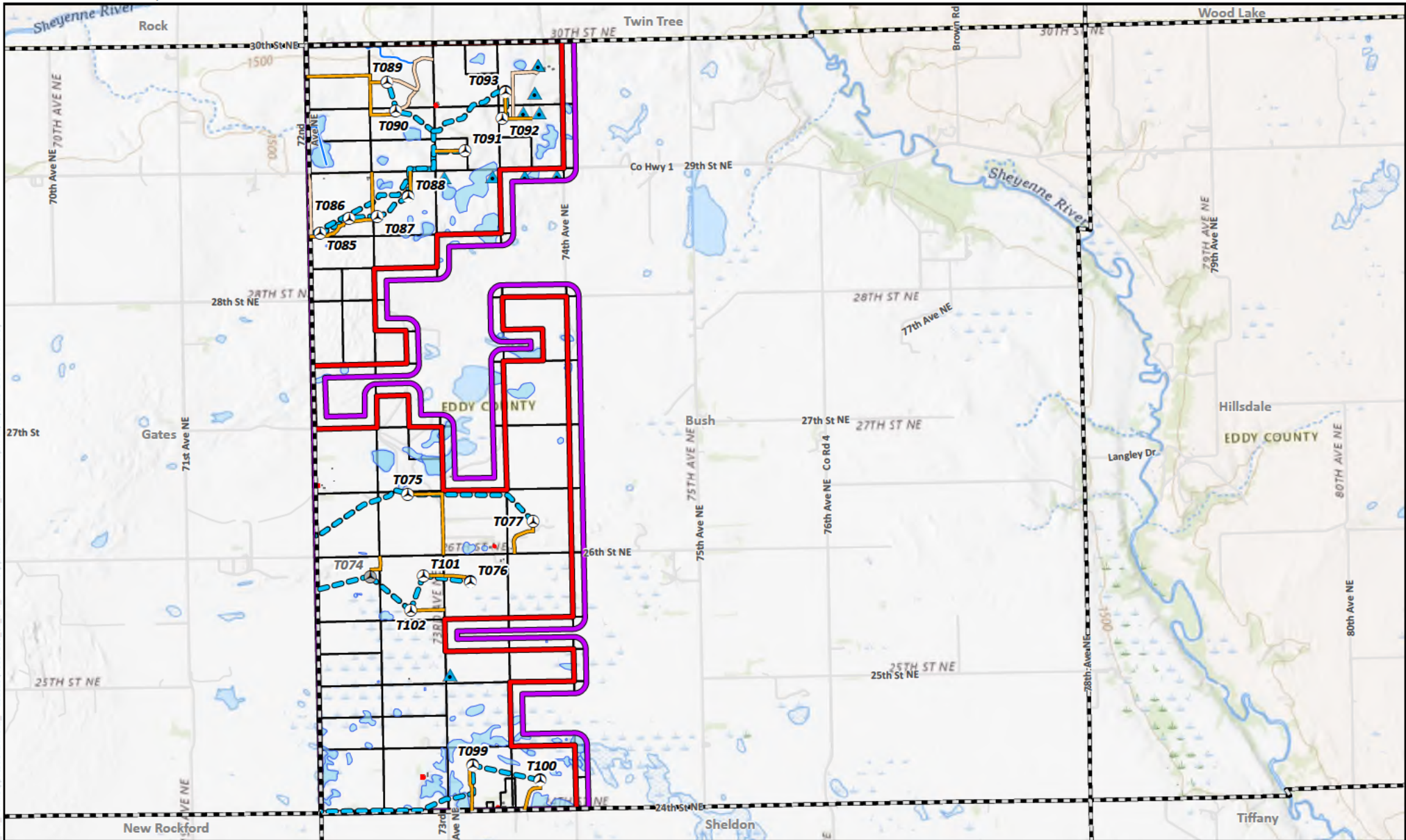

Data Source(s): Westwood (2025); Esri WMS Topo & World Street Basemaps (Accessed 2025); U.S. Census Bureau (2024), OGD (2024), HIFLD (2022), NHD (2024); FAA (2023).



Westwood
Toll Free (888) 937-5150 westwoodps.com

Flickertail Wind Project

Project Design & Existing Infrastructure

Legend

- | | | | |
|------------------------------|---------------------|-----------------------|-------------------|
| Project Area | Occupied Receptor | Access Road | Alternate Turbine |
| Project Area 500-Foot Buffer | Unoccupied Receptor | Alternate Access Road | Gas Well |
| Township Boundary | NHD Waterbody | Collection Line | Water Well |
| Parcel Boundary | NHD Flowline | Turbine | |

Bush Township, Eddy County, North Dakota

Exhibit 1

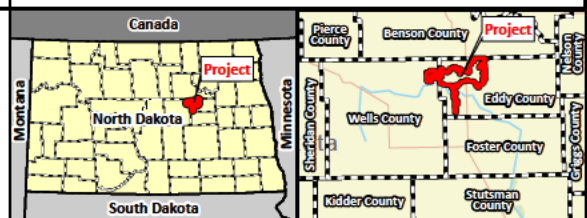

Appendix A Map 4 - Gates Township Project Design and Existing Infrastructure

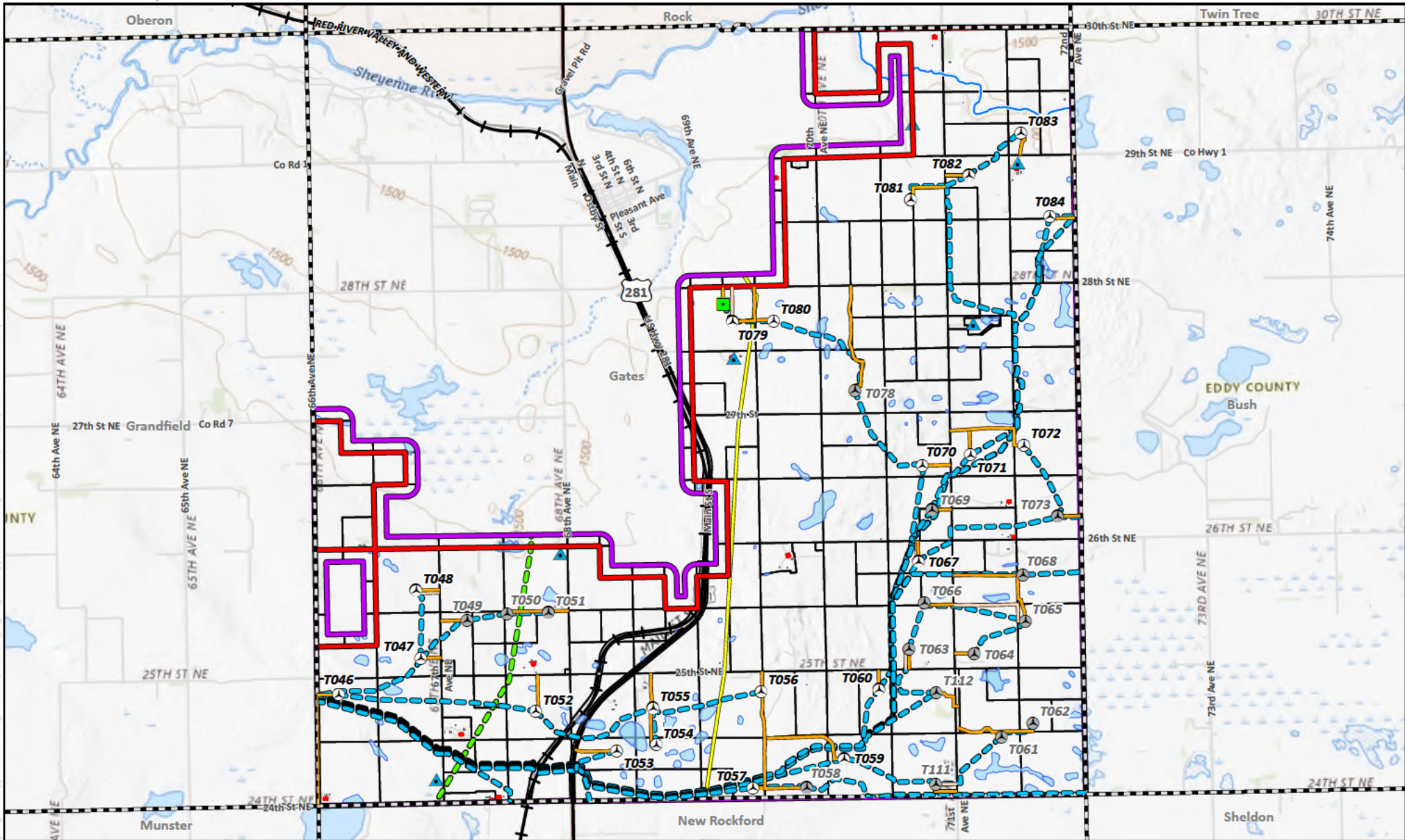

Data Source(s): Westwood (2025); Esri WMS Topo & World Street Basemaps (Accessed 2025); U.S. Census Bureau (2024), OGD (2024), HIFLD (2022), NHD (2024); FAA (2023).



Westwood
Toll Free (888) 937-5150 westwoodps.com

Flickertail Wind Project

Project Design & Existing Infrastructure

Legend

- | | | | |
|------------------------------|----------------------------|-----------------------|-------------------|
| Project Area | Unoccupied Receptor | Access Road | Turbine |
| Project Area 500-Foot Buffer | NHD Waterbody | Alternate Access Road | Alternate Turbine |
| Township Boundary | NHD Flowline | Collection Line | MET Tower |
| Parcel Boundary | Existing Transmission Line | Major Road | Water Well |
| Occupied Receptor | Gas Pipeline | Railroad | |

Gates Township, Eddy County, North Dakota

Exhibit 1

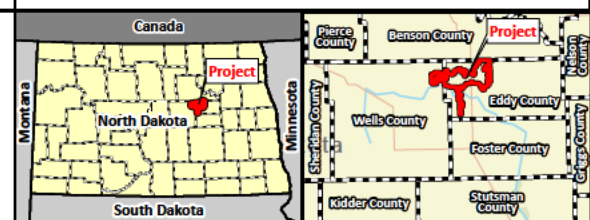

Appendix A Map 5 – Munster Township Project Design and Existing Infrastructure

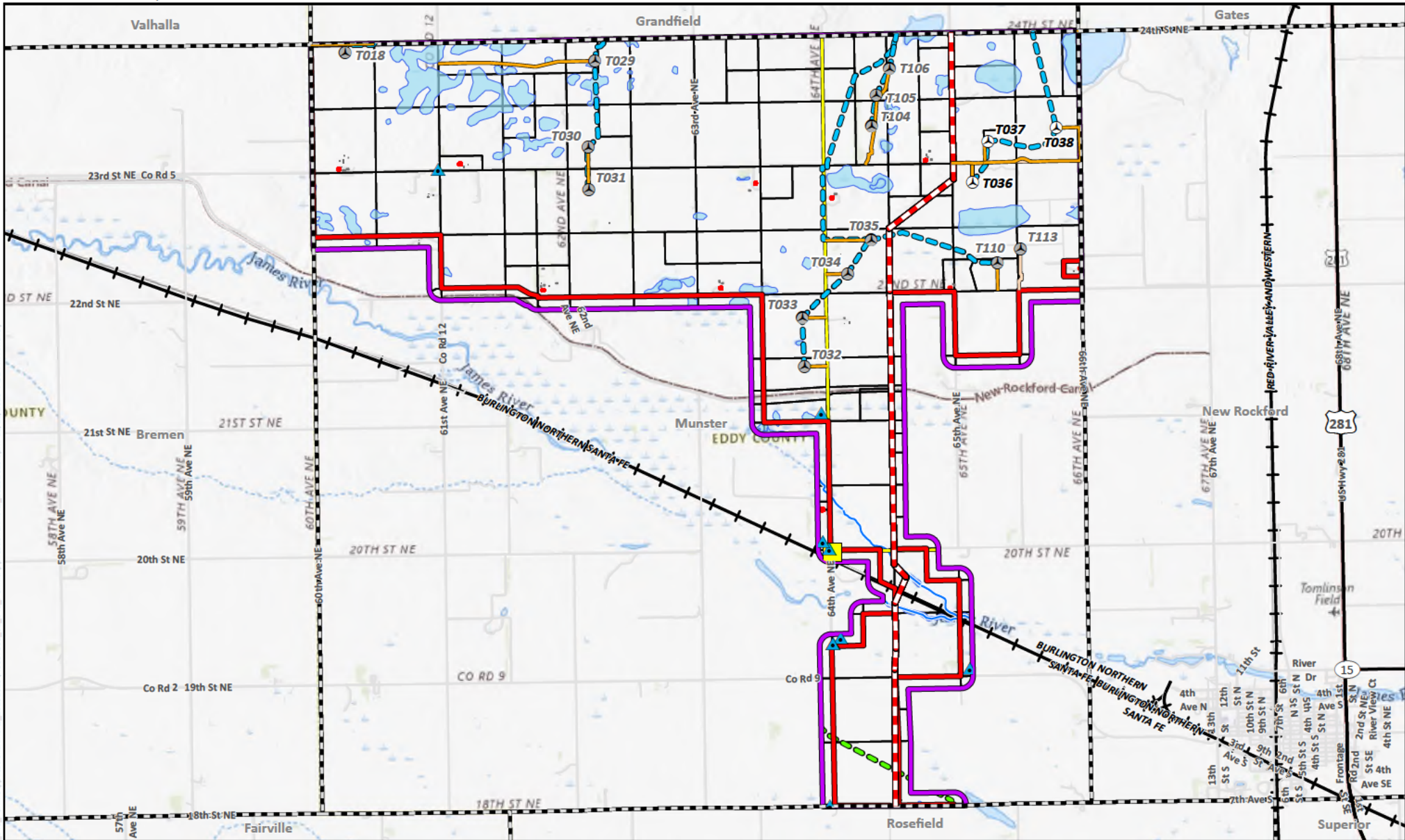

Data Source(s): Westwood (2025); Esri WMS Topo & World Street Basemaps (Accessed 2025); U.S. Census Bureau (2024); OGD (2024); HIFLD (2022); NHD (2024); FAA (2023).



Westwood
Toll Free (888) 937-5150 westwoodps.com

Flickertail Wind Project

Project Design & Existing Infrastructure

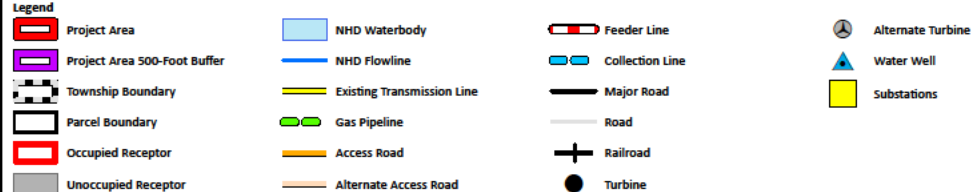

Munster Township, Eddy County, North Dakota

Exhibit 1

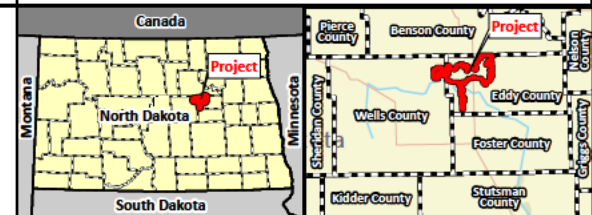

Appendix A Map 6 – Sheldon Township Project Design and Existing Infrastructure

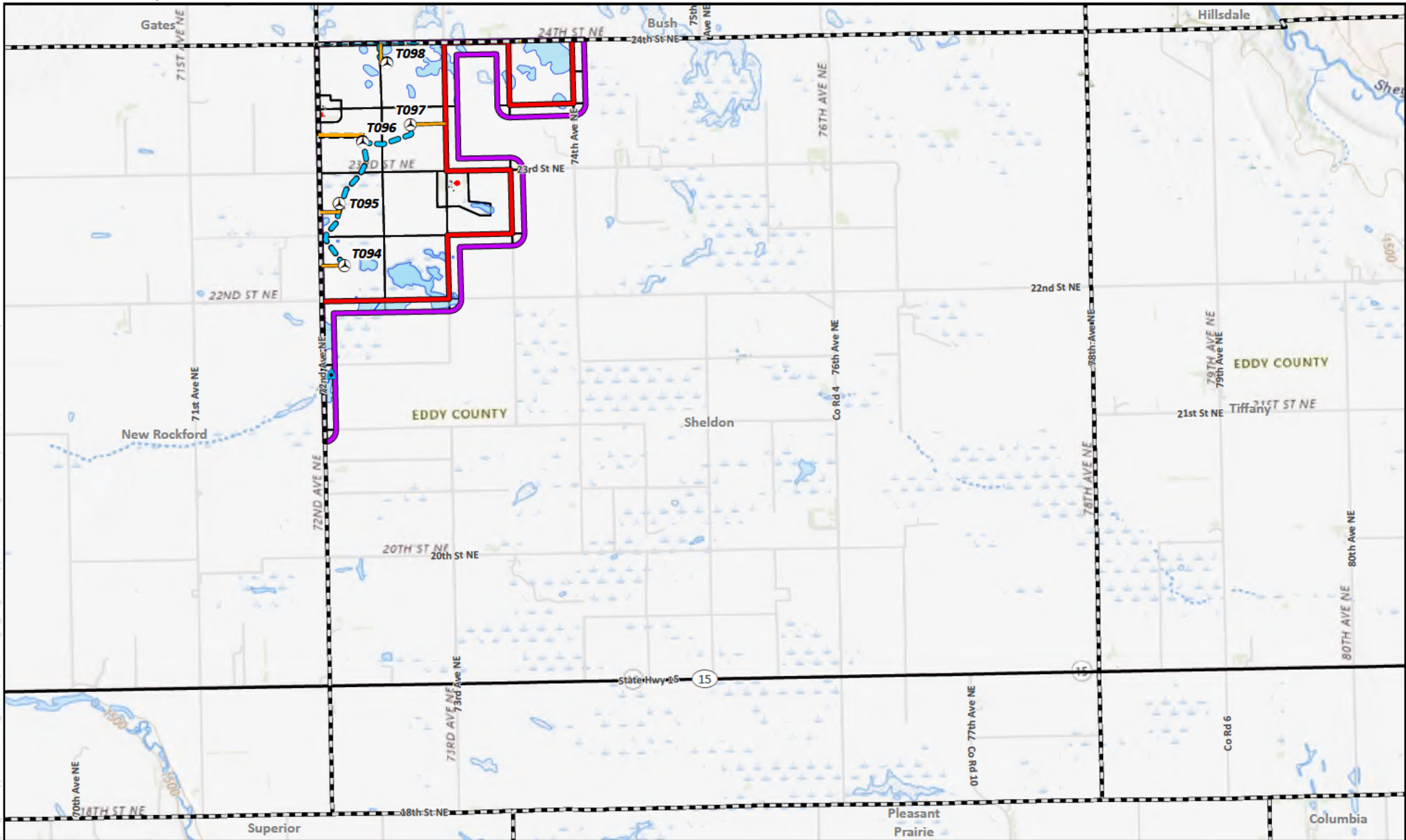

Data Source(s): Westwood (2025); Esri WMS Topo & World Street Basemaps (Accessed 2025); U.S. Census Bureau (2024), OGD (2024), HIFLD (2022), NHD (2024); FAA (2023).



Westwood
Toll Free (888) 937-5150 westwoodps.com

Flickertail Wind Project

Project Design & Existing Infrastructure

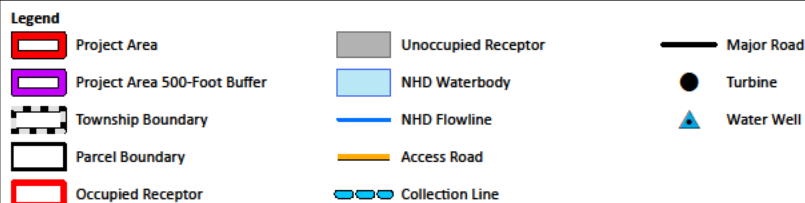

Sheldon Township, Eddy County, North Dakota

Exhibit 1

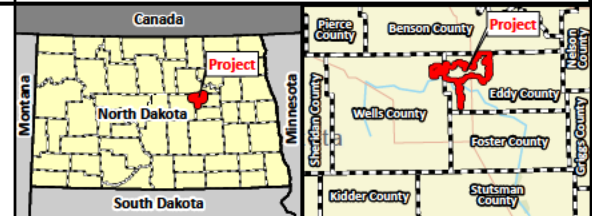

Appendix A Map 7 – Rosefield Township Project Design and Existing Infrastructure

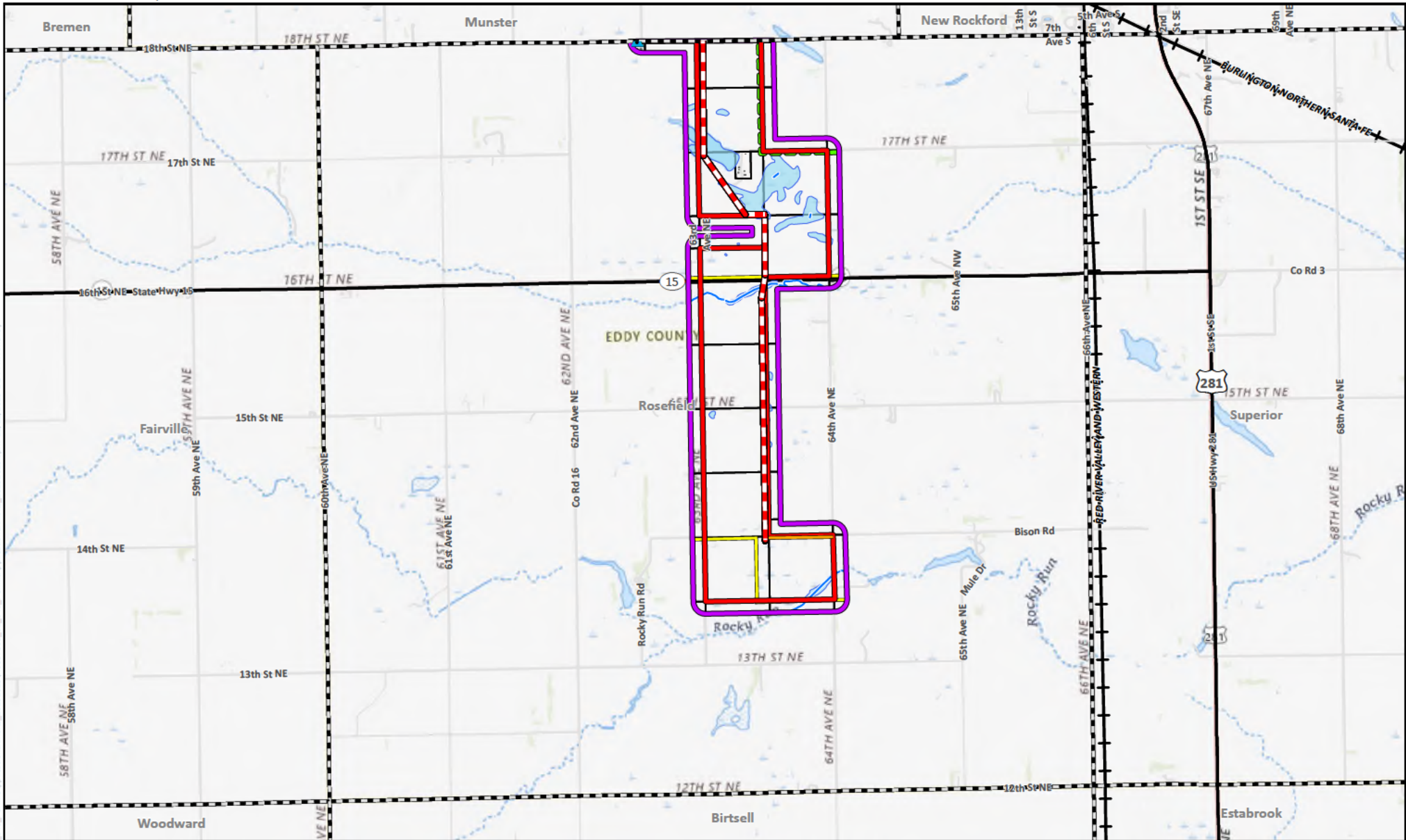

Data Source(s): Westwood (2025); Esri WMS Topo & World Street Basemaps (Accessed 2025); U.S. Census Bureau (2024); OGD (2024); HIFLD (2022); NHD (2024); FAA (2023).



Westwood
Toll Free (888) 937-5150 westwoodps.com

Flickertail Wind Project

Project Design & Existing Infrastructure

Legend

- | | | | |
|------------------------------|----------------------------|--------------|------------|
| Project Area | Unoccupied Receptor | Gas Pipeline | Road |
| Project Area 500-Foot Buffer | NHD Waterbody | Access Road | Railroad |
| Township Boundary | NHD Flowline | Feeder Line | Water Well |
| Parcel Boundary | Existing Transmission Line | Major Road | |

Rosefield Township, Eddy County, North Dakota

Exhibit 1

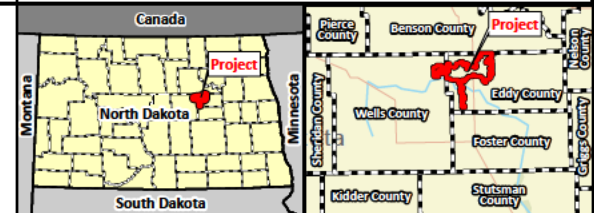

Appendix B – Participating Landowner List and Memorandum of Real Estate Agreements

| Landowner(s) | Parcel # | County | Township |
|--|----------------|--------|-----------|
| Allmaras, Brett; Allmaras, John (Kenmar) | 06000001040000 | Eddy | Rosefield |
| Allmaras, Brett; Allmaras, John (Kenmar) | 06000001041000 | Eddy | Rosefield |
| Allmaras, Brett; Allmaras, John (Kenmar) | 06000001044000 | Eddy | Rosefield |
| Allmaras, Keven | 12000002461000 | Eddy | Munster |
| Allmaras, Tim & Judy | 06000001004000 | Eddy | Rosefield |
| Allmaras, Tim & Judy | 06000001005000 | Eddy | Rosefield |
| Allmaras, Tim & Judy | 12000002526000 | Eddy | Munster |
| Allmaras, Tim & Judy | 12000002527000 | Eddy | Munster |
| Allmaras, Todd | 06000001035000 | Eddy | Rosefield |
| Anderson, Gary; Norman, Emily; Rust, Margaret | 17000003866000 | Eddy | Gates |
| Anderson, Michael | 16000003567000 | Eddy | Bush |
| Benson, Gordon & Colleen | 17000003893000 | Eddy | Gates |
| Benson, Gordon & Colleen | 17000003894000 | Eddy | Gates |
| Benson, Gordon & Colleen | 17000003898000 | Eddy | Gates |
| Benson, Gordon & Colleen | 17000003899000 | Eddy | Gates |
| Benson, Gordon & Colleen | 17000003900000 | Eddy | Gates |
| Benson, Gordon & Colleen | 17000003902000 | Eddy | Gates |
| Benson, Gordon & Colleen | 17000003956000 | Eddy | Gates |
| Benson, Roger & Collen | 17000003975000 | Eddy | Gates |
| Birkeland, Daniel & Karen | 16000003559000 | Eddy | Bush |
| Birkeland, Daniel & Karen | 16000003560000 | Eddy | Bush |
| Birkeland, Daniel & Karen | 16000003564000 | Eddy | Bush |
| Birkeland, Daniel & Karen | 16000003634100 | Eddy | Bush |
| Birkeland, Daniel & Karen | 16000003638000 | Eddy | Bush |
| Bollingberg, Kurt & Cheryl; Trust Agreement of Mary G. Wiltse; The 2002 Reitan Family Revocable Trust; Irvin, Mari | 12000002321000 | Eddy | Munster |
| Bollingberg, Kurt & Cheryl; Trust Agreement of Mary G. Wiltse; The 2002 Reitan Family Revocable Trust; Irvin, Mari | 12000002358000 | Eddy | Munster |
| Bollingberg, Kurt & Cheryl; Trust Agreement of Mary G. Wiltse; The 2002 Reitan Family Revocable Trust; Irvin, Mari | 12000002361000 | Eddy | Munster |
| Brash, Rachael; Brash, Anna; Brash, Elsa | 12000002326000 | Eddy | Munster |
| Brash, Rachael; Brash, Anna; Brash, Elsa | 12000002335000 | Eddy | Munster |
| Brash, Rachael; Brash, Anna; Brash, Elsa | 12000002359000 | Eddy | Munster |
| Brash, Rachael; Brash, Anna; Brash, Elsa | 12000002360000 | Eddy | Munster |
| Brash, Rachael; Brash, Anna; Brash, Elsa | 12000002362000 | Eddy | Munster |
| Brash, Rachael; Brash, Anna; Brash, Elsa | 12000002367000 | Eddy | Munster |
| Bush, Anthony & Julia | 12000002312000 | Eddy | Munster |
| Bush, Anthony & Julia | 12000002363000 | Eddy | Munster |
| Bush, Anthony & Julia | 12000002372000 | Eddy | Munster |
| Carlson, C. Mauritz | 17000003761000 | Eddy | Gates |

| | | | |
|--|----------------|------|-----------|
| Carlson, C. Mauritz | 17000003762100 | Eddy | Gates |
| Carlson, C. Mauritz | 17000003764000 | Eddy | Gates |
| Carlson, C. Mauritz | 17000003767000 | Eddy | Gates |
| Carlson, C. Mauritz | 17000003769100 | Eddy | Gates |
| Carlson, C. Mauritz | 17000003772100 | Eddy | Gates |
| Carlson, C. Mauritz | 17000003775000 | Eddy | Gates |
| Cleveland, James & Gayle | 10000001789000 | Eddy | Sheldon |
| Cleveland, James & Gayle | 10000001790000 | Eddy | Sheldon |
| Cleveland, James & Gayle | 10000001791000 | Eddy | Sheldon |
| Darlene A. Daugherty Family Land Trust | 17000004011000 | Eddy | Gates |
| Darlene A. Daugherty Family Land Trust | 17000004012000 | Eddy | Gates |
| Daugherty, Carl | 17000003993000 | Eddy | Gates |
| Daugherty, Carl | 17000003998000 | Eddy | Gates |
| EP Sons LLP | 17000003930000 | Eddy | Gates |
| EP Sons LLP | 17000003931000 | Eddy | Gates |
| EP Sons LLP | 17000004017000 | Eddy | Gates |
| EP Sons LLP | 17000004022000 | Eddy | Gates |
| EP Sons LLP | 17000004023000 | Eddy | Gates |
| Gehertz, David & Patricia | 16000003699000 | Eddy | Bush |
| Geisinger, Gary | 12000002351000 | Eddy | Munster |
| Geisinger, Gary | 12000002352100 | Eddy | Munster |
| Guler, Randy & Serena | 06000001043000 | Eddy | Rosefield |
| Guler, Randy & Serena | 06000001062000 | Eddy | Rosefield |
| Hartl, Eugene & Mary | 12000002307000 | Eddy | Munster |
| Hartl, Eugene & Mary | 12000002308000 | Eddy | Munster |
| Hartl, Eugene & Mary | 12000002310000 | Eddy | Munster |
| Hartl, Eugene & Mary | 12000002311000 | Eddy | Munster |
| Hartl, Eugene & Mary | 12000002314000 | Eddy | Munster |
| Hartl, Eugene & Mary | 12000002316000 | Eddy | Munster |
| Hartl, Eugene & Mary | 12000002319000 | Eddy | Munster |
| Hartl, Eugene & Mary | 12000002370000 | Eddy | Munster |
| Hegland, Dennis; OJA Gjellstad Irrevocable Trust; Steckler, Roberta; Blilie, Marilyn; Hegland, Gary | 12000002301000 | Eddy | Munster |
| Hegland, Dennis; OJA Gjellstad Irrevocable Trust; Steckler, Roberta; Blilie, Marilyn; Hegland, Gary | 12000002302300 | Eddy | Munster |
| Hegland, Dennis; OJA Gjellstad Irrevocable Trust; Steckler, Roberta; Blilie, Marilyn; Hegland, Gary | 12000002302600 | Eddy | Munster |
| Hegland, Dennis; OJA Gjellstad Irrevocable Trust; Steckler, Roberta; Blilie, Marilyn; Hegland, Gary | 12000002303300 | Eddy | Munster |
| Hegland, Dennis; OJA Gjellstad Irrevocable Trust; Steckler, Roberta; Blilie, Marilyn; Hegland, Gary | 12000002303600 | Eddy | Munster |
| Hegland, Dennis; OJA Gjellstad Irrevocable Trust; Steckler, Roberta; Blilie, Marilyn; Hegland, Gary | 12000002304000 | Eddy | Munster |

| | | | |
|--|----------------|------|-----------|
| Hegland, Dennis; OJA Gjellstad Irrevocable Trust; Steckler, Roberta; Blilie, Marilyn; Hegland, Gary | 12000002306000 | Eddy | Munster |
| Hegland, Dennis; OJA Gjellstad Irrevocable Trust; Steckler, Roberta; Blilie, Marilyn; Hegland, Gary | 12000002313300 | Eddy | Munster |
| Hegland, Dennis; OJA Gjellstad Irrevocable Trust; Steckler, Roberta; Blilie, Marilyn; Hegland, Gary | 12000002313600 | Eddy | Munster |
| Hegland, Dennis; OJA Gjellstad Irrevocable Trust; Steckler, Roberta; Blilie, Marilyn; Hegland, Gary | 12000002369000 | Eddy | Munster |
| Helseth, Brent & Jenna | 12000002378300 | Eddy | Munster |
| Helseth, Brent & Jenna | 12000002381000 | Eddy | Munster |
| Hoffman, Jr., Robert & Sandra | 12000002374600 | Eddy | Munster |
| Hoffman, Jr., Robert & Sandra | 12000002378600 | Eddy | Munster |
| James W. Schaefer, LLLP | 12000002323000 | Eddy | Munster |
| James W. Schaefer, LLLP | 12000002328000 | Eddy | Munster |
| James W. Schaefer, LLLP | 12000002331000 | Eddy | Munster |
| Kenmar Bison Ranch LLP | 06000001094100 | Eddy | Rosefield |
| Kenmar Bison Ranch LLP | 06000001097000 | Eddy | Rosefield |
| Koepplin, Todd & Karen | 06000001094000 | Eddy | Rosefield |
| Langley, Richard | 16000003695000 | Eddy | Bush |
| Langley, Richard | 16000003698000 | Eddy | Bush |
| Langley, Richard | 16000003702000 | Eddy | Bush |
| Langley, Richard | 16000003703000 | Eddy | Bush |
| Langley, Richard | 16000003706000 | Eddy | Bush |
| McDonald, Justin Trust | 16000003645000 | Eddy | Bush |
| McDonald, Justin Trust | 16000003648000 | Eddy | Bush |
| Messner, Jacob; Messner, Tyler; Messner, Nathan | 16000003700000 | Eddy | Bush |
| Messner, Jacob; Messner, Tyler; Messner, Nathan | 16000003701000 | Eddy | Bush |
| Messner, Jacob; Messner, Tyler; Messner, Nathan | 17000003897000 | Eddy | Gates |
| Messner, Jacob; Messner, Tyler; Messner, Nathan | 17000003960000 | Eddy | Gates |
| Messner, Jacob; Messner, Tyler; Messner, Nathan | 17000003962000 | Eddy | Gates |
| Messner, Jacob; Messner, Tyler; Messner, Nathan | 17000003963000 | Eddy | Gates |
| Messner, Jacob; Messner, Tyler; Messner, Nathan | 17000003964000 | Eddy | Gates |
| Messner, Jacob; Messner, Tyler; Messner, Nathan | 17000003965000 | Eddy | Gates |
| Messner, Jacob; Messner, Tyler; Messner, Nathan | 17000003966000 | Eddy | Gates |
| Messner, Jacob; Messner, Tyler; Messner, Nathan | 17000003967000 | Eddy | Gates |
| Messner, Jacob; Messner, Tyler; Messner, Nathan | 17000003970000 | Eddy | Gates |
| Messner, Jacob; Messner, Tyler; Messner, Nathan | 17000003973000 | Eddy | Gates |
| Messner, Steve & Barbara | 16000003575000 | Eddy | Bush |
| Messner, Steve & Barbara | 16000003576000 | Eddy | Bush |
| Messner, Steve & Barbara | 16000003640000 | Eddy | Bush |
| Messner, Steve & Barbara | 16000003642000 | Eddy | Bush |
| Messner, Steve & Barbara | 16000003643000 | Eddy | Bush |
| Messner, Steve & Barbara | 16000003647000 | Eddy | Bush |

| | | | |
|--------------------------------------|----------------|------|---------|
| Messner, Steve & Barbara | 16000003649000 | Eddy | Bush |
| Messner, Steve & Barbara | 16000003650000 | Eddy | Bush |
| Messner, Steve & Barbara | 16000003651000 | Eddy | Bush |
| Messner, Steve & Barbara | 17000003871000 | Eddy | Gates |
| Messner, Steve & Barbara | 17000003881000 | Eddy | Gates |
| Messner, Steve & Barbara | 17000003882000 | Eddy | Gates |
| Messner, Steve & Barbara | 17000003883000 | Eddy | Gates |
| Messner, Steve & Barbara | 17000003887000 | Eddy | Gates |
| Messner, Steve & Barbara | 17000003888000 | Eddy | Gates |
| Messner, Steve & Barbara | 17000003889000 | Eddy | Gates |
| Messner, Steve & Barbara | 17000003895000 | Eddy | Gates |
| Myhre, Eric & Sara | 17000004022300 | Eddy | Gates |
| Myhre, James & Shirley | 12000002379100 | Eddy | Munster |
| Myhre, Jerry & Karen Revocable Trust | 17000004014000 | Eddy | Gates |
| Myhre, Kent & Alyson | 17000003999000 | Eddy | Gates |
| Myhre, Kent & Alyson | 17000004000000 | Eddy | Gates |
| Myhre, Kent & Alyson | 17000004002000 | Eddy | Gates |
| Myhre, Kent & Alyson | 17000004004000 | Eddy | Gates |
| Myhre, Kent & Alyson | 17000004005000 | Eddy | Gates |
| Myhre, Kent & Alyson | 17000004006000 | Eddy | Gates |
| Myhre, Kent & Alyson | 17000004013000 | Eddy | Gates |
| Myhre, Kent & Alyson | 17000004020300 | Eddy | Gates |
| Myhre, Kent & Alyson | 17000004021000 | Eddy | Gates |
| Myhre, Kent & Alyson | 17000004020600 | Eddy | Gates |
| Myhre, Nyle & Lavonne | 17000004015000 | Eddy | Gates |
| Noack Family Farms Partnership, LLLP | 12000002324000 | Eddy | Munster |
| Noack Family Farms Partnership, LLLP | 12000002325000 | Eddy | Munster |
| Noack Family Farms Partnership, LLLP | 12000002330000 | Eddy | Munster |
| Noack Family Farms Partnership, LLLP | 12000002368000 | Eddy | Munster |
| Noack Family Farms Partnership, LLLP | 12000002373000 | Eddy | Munster |
| Noack Family Farms Partnership, LLLP | 12000002387000 | Eddy | Munster |
| Noack Family Farms Partnership, LLLP | 12000002388000 | Eddy | Munster |
| Noack Family Farms Partnership, LLLP | 12000002394000 | Eddy | Munster |
| Noack Family Farms Partnership, LLLP | 12000002400000 | Eddy | Munster |
| Noack Family Farms Partnership, LLLP | 12000002459000 | Eddy | Munster |
| Noack Family Farms Partnership, LLLP | 17000004035000 | Eddy | Gates |
| Noack Family Farms Partnership, LLLP | 17000004039000 | Eddy | Gates |
| Noack Family Farms Partnership, LLLP | 17000004040000 | Eddy | Gates |
| Noack Family Farms Partnership, LLLP | 17000004043000 | Eddy | Gates |
| Noack Family Farms Partnership, LLLP | 17000004045000 | Eddy | Gates |
| Olson, John; Olson, David | 17000003982000 | Eddy | Gates |
| Olson, John; Olson, David | 17000003984000 | Eddy | Gates |
| Olson, John; Olson, David | 17000003992000 | Eddy | Gates |

| | | | |
|--|----------------|------|-----------|
| Olson, John; Olson, David | 17000003996000 | Eddy | Gates |
| Olson, John; Olson, David | 17000003997000 | Eddy | Gates |
| Olson, John; Olson, David | 17000004024000 | Eddy | Gates |
| Olson, John; Olson, David | 17000004028000 | Eddy | Gates |
| Olson, John; Olson, David | 17000004031000 | Eddy | Gates |
| Olson, John; Olson, David | 17000004032000 | Eddy | Gates |
| Olson, John; Olson, David | 17000004034000 | Eddy | Gates |
| Olson, Thomas | 17000003969000 | Eddy | Gates |
| Olson, Thomas | 17000003972000 | Eddy | Gates |
| Olson, Thomas | 17000003976000 | Eddy | Gates |
| Olson, Thomas | 17000003978000 | Eddy | Gates |
| Olson, Thomas | 17000004036000 | Eddy | Gates |
| Olson, Thomas | 17000004037000 | Eddy | Gates |
| RCT, LLLP | 17000003961000 | Eddy | Gates |
| Sattler, Susan; Gerard and Mary Kay Baker Living Trust; Bickler, Michael; Sellie, Julianne; Johnson, Barbara; | 10000001785600 | Eddy | Sheldon |
| Sattler, Susan; Gerard and Mary Kay Baker Living Trust; Bickler, Michael; Sellie, Julianne; Johnson, Barbara; | 10000001786600 | Eddy | Sheldon |
| Schaefer, Monty & Tori | 06000001092000 | Eddy | Rosefield |
| Schaefer, Monty & Tori | 06000001093000 | Eddy | Rosefield |
| Schaefer, Monty & Tori | 06000001113000 | Eddy | Rosefield |
| Schuster, Jerry & Penny | 12000002350100 | Eddy | Munster |
| Schuster, Jerry & Penny | 12000002354000 | Eddy | Munster |
| Schuster, Jerry & Penny | 12000002354100 | Eddy | Munster |
| Silbernagel, Dennis | 12000002376000 | Eddy | Munster |
| Silbernagel, Dennis Trust | 12000002375000 | Eddy | Munster |
| Silbernagel, Thomas Trust | 12000002377000 | Eddy | Munster |
| Silbernagel, Thomas Trust | 12000002379000 | Eddy | Munster |
| Smith, Jr., Charles & Elaine | 16000003652000 | Eddy | Bush |
| Smith, Jr., Charles & Elaine | 16000003654000 | Eddy | Bush |
| Smith, Jr., Charles & Elaine | 16000003655000 | Eddy | Bush |
| Smith, Jr., Charles & Elaine | 16000003693000 | Eddy | Bush |
| Smith, Jr., Charles & Elaine | 16000003694000 | Eddy | Bush |
| Soderholm, Beverly; Soderholm, John; Soderholm, Paul; Hanson, Cynthia | 16000003584000 | Eddy | Bush |
| Soderholm, John; Soderholm, Paul | 17000003867000 | Eddy | Gates |
| Soderholm, John; Soderholm, Paul | 17000003868000 | Eddy | Gates |
| Soderholm, John; Soderholm, Paul | 17000003870000 | Eddy | Gates |
| Soderholm, John; Soderholm, Paul | 17000003875000 | Eddy | Gates |
| Soderholm, John; Soderholm, Paul | 17000003876000 | Eddy | Gates |
| Soderholm, John; Soderholm, Paul | 17000003877000 | Eddy | Gates |
| Soderholm, John; Soderholm, Paul | 17000003879000 | Eddy | Gates |
| Steinbach, David & Kathleen | 12000002337000 | Eddy | Munster |

| | | | |
|---|----------------|------|---------|
| Steinbach, David & Kathleen | 12000002338000 | Eddy | Munster |
| Steinbach, David & Kathleen | 12000002339000 | Eddy | Munster |
| Steinbach, David & Kathleen | 12000002340000 | Eddy | Munster |
| Steinbach, David & Kathleen | 12000002341000 | Eddy | Munster |
| Steinbach, David & Kathleen | 12000002342000 | Eddy | Munster |
| Steinbach, David & Kathleen | 12000002350000 | Eddy | Munster |
| Steinbach, David & Kathleen | 12000002354300 | Eddy | Munster |
| Steinbach, David & Kathleen | 12000002356000 | Eddy | Munster |
| Thompson, Nickolia A. & Jacqueline | 16000003561000 | Eddy | Bush |
| Thompson, Nickolia A. & Jacqueline | 16000003562300 | Eddy | Bush |
| Thompson, Nickolia A. & Jacqueline | 16000003563000 | Eddy | Bush |
| Thompson, Ryan | 16000003562600 | Eddy | Bush |
| Throlson, LeRoy & Eunice | 16000003565000 | Eddy | Bush |
| Throlson, LeRoy & Eunice | 16000003571000 | Eddy | Bush |
| Throlson, LeRoy & Eunice | 16000003572000 | Eddy | Bush |
| Throlson, LeRoy & Eunice | 16000003573000 | Eddy | Bush |
| Throlson, LeRoy & Eunice | 16000003574000 | Eddy | Bush |
| Throlson, LeRoy & Eunice | 16000003577000 | Eddy | Bush |
| Throlson, LeRoy & Eunice | 16000003581000 | Eddy | Bush |
| Throlson, LeRoy & Eunice | 17000003765000 | Eddy | Gates |
| Throlson, LeRoy & Eunice | 17000003768000 | Eddy | Gates |
| Throlson, LeRoy & Eunice | 17000003859000 | Eddy | Gates |
| Throlson, LeRoy & Eunice | 17000003864000 | Eddy | Gates |
| Throlson, LeRoy & Eunice | 17000003873000 | Eddy | Gates |
| Throlson, LeRoy & Eunice | 17000003874000 | Eddy | Gates |
| Throlson, LeRoy & Eunice | 17000003878000 | Eddy | Gates |
| Throlson, LeRoy & Eunice | 17000003880000 | Eddy | Gates |
| Throlson, Scott | 17000003927000 | Eddy | Gates |
| Throlson, Scott | 17000003932000 | Eddy | Gates |
| Tuntland Family Living Trust; Carol M. Rosenau Family Trust; Fox, Ilo | 17000003987000 | Eddy | Gates |
| Tuntland Family Living Trust; Carol M. Rosenau Family Trust; Fox, Ilo | 17000003990000 | Eddy | Gates |
| Tuntland Family Living Trust; Carol M. Rosenau Family Trust; Fox, Ilo | 17000003991000 | Eddy | Gates |
| Tuntland Family Living Trust; Carol M. Rosenau Family Trust; Fox, Ilo | 17000003995000 | Eddy | Gates |
| Tuntland Family Living Trust; Carol M. Rosenau Family Trust; Fox, Ilo | 17000004001300 | Eddy | Gates |
| Tuntland Family Living Trust; Carol M. Rosenau Family Trust; Fox, Ilo | 17000004018000 | Eddy | Gates |
| Tuntland Family Living Trust; Carol M. Rosenau Family Trust; Fox, Ilo | 17000004019000 | Eddy | Gates |

| | | | |
|---|----------------|------|-----------|
| Walker, Frank & Georgianna | 12000002371000 | Eddy | Munster |
| Walker, Frank & Georgianna | 12000002374300 | Eddy | Munster |
| Walker, Frank & Georgianna | 12000002390000 | Eddy | Munster |
| Walker, Frank & Georgianna | 12000002392300 | Eddy | Munster |
| Walz Family Land LLLP | 06000001063000 | Eddy | Rosefield |
| Weber, Casey; Weber, Levi | 17000004027000 | Eddy | Gates |
| Weber, Casey; Weber, Levi | 17000004029000 | Eddy | Gates |
| Weber, Casey; Weber, Levi | 17000004033000 | Eddy | Gates |
| Weber, Darin & Diana | 10000001780000 | Eddy | Sheldon |
| Weber, Darin & Diana | 16000003711000 | Eddy | Bush |
| Weber, Darin & Diana | 16000003712000 | Eddy | Bush |
| Weber, Darin & Diana | 16000003714000 | Eddy | Bush |
| Weber, Darin & Diana | 17000004047000 | Eddy | Gates |
| Weber, Darin & Diana; Weber, Dennis & LeAnn | 16000003712300 | Eddy | Bush |
| Weber, Darin & Diana; Weber, Dennis & LeAnn | 16000003714300 | Eddy | Bush |
| Weber, Dennis & LeAnn | 10000001784000 | Eddy | Sheldon |
| Weber, Dennis & LeAnn | 10000001787000 | Eddy | Sheldon |
| Weber, Dennis & LeAnn | 16000003708000 | Eddy | Bush |
| Weber, Dennis & LeAnn | 16000003709000 | Eddy | Bush |
| Weber, Dennis & LeAnn | 17000004048000 | Eddy | Gates |
| Weber, Todd; Weber, Paul; Weber, Misty | 12000002456000 | Eddy | Munster |
| Weber, Todd; Weber, Paul; Weber, Misty | 12000002457000 | Eddy | Munster |
| Weber, Todd; Weber, Paul; Weber, Misty | 12000002462000 | Eddy | Munster |
| Weber, Todd; Weber, Paul; Weber, Misty | 12000002463000 | Eddy | Munster |
| Weber, Todd; Weber, Paul; Weber, Misty | 12000002477000 | Eddy | Munster |
| Weber, Todd; Weber, Paul; Weber, Misty | 12000002481000 | Eddy | Munster |
| Werre, Steve & Patti Jo | 10000001788300 | Eddy | Sheldon |
| Werre, Steve & Patti Jo | 10000001788600 | Eddy | Sheldon |
| Werre, Steve & Patti Jo | 10000001793300 | Eddy | Sheldon |
| Werre, Steve & Patti Jo | 10000001793600 | Eddy | Sheldon |
| Westerhausen, Bonnie; Meredith, Rebecca; Westerhausen, Chad; Martin, Paula; Warren, Dean; Warren, Matthew; Warren, Jacob; Belquist, Elisabeth | 17000003955000 | Eddy | Gates |
| Westerhausen, Bonnie; Meredith, Rebecca; Westerhausen, Chad; Martin, Paula; Warren, Dean; Warren, Matthew; Warren, Jacob; Belquist, Elisabeth | 17000003957000 | Eddy | Gates |
| Westerhausen, Bonnie; Meredith, Rebecca; Westerhausen, Chad; Martin, Paula; Warren, Dean; Warren, Matthew; Warren, Jacob; Belquist, Elisabeth | 17000003958000 | Eddy | Gates |
| Westerhausen, Bonnie; Meredith, Rebecca; Westerhausen, Chad; Martin, Paula; Warren, Dean; Warren, Matthew; Warren, Jacob; Belquist, Elisabeth | 17000003959000 | Eddy | Gates |

| | | | |
|---|----------------|------|---------|
| Westerhausen, Bonnie; Meredith, Rebecca; Westerhausen, Chad; Martin, Paula; Warren, Dean; Warren, Matthew; Warren, Jacob; Belquist, Elisabeth | 17000003971000 | Eddy | Gates |
| Westerhausen, Bonnie; Meredith, Rebecca; Westerhausen, Chad; Martin, Paula; Warren, Dean; Warren, Matthew; Warren, Jacob; Belquist, Elisabeth | 17000003974000 | Eddy | Gates |
| Whetham, Geneva | 12000002478000 | Eddy | Munster |
| Whetham, Geneva | 12000002483000 | Eddy | Munster |
| Whetham, Geneva | 12000002485000 | Eddy | Munster |
| Whetham, Geneva | 12000002523000 | Eddy | Munster |
| Whetham, Geneva | 12000002525000 | Eddy | Munster |
| Zajac, Raymond | 17000003994000 | Eddy | Gates |
| Zajac, Raymond | 17000004025000 | Eddy | Gates |
| Zajac, Raymond | 17000004026000 | Eddy | Gates |